

74c King Street
Knutsford



Stuart
Rushton
& COMPANY

A simply superb top floor penthouse with the most fantastic panoramic views over Knutsford and The Moor, boasting a bank of glass doors leading out to a full length balcony overlooking the top of King Street and beyond

The Royal George scheme was completed in 2007 by the excellent P H Property Holdings, and comprises a mixture of apartments, town houses and town centre shops. 74c is the prime property on the scheme, one of just four large apartments in a separate block, and is situated on the top floor with wonderful views over King Street, towards Tatton Moor and beyond. It is accessed via a semi private lift off King Street (next to Waterstones) and has secure underground car parking for two cars, accessed off Regent Street.

The apartment is beautifully presented and at around 1200 square feet feels very spacious, boasting newly installed Ted Todd floors and carpeting throughout. A superb, bright double reception room with full height glazing provides an open living dining space and two sets of double doors lead out to the large balcony. The kitchen is open to the living dining area and is fitted with base and eye level cabinets and a range of integrated appliances. The utility room is accessed from the kitchen area.





There are three good sized bedrooms, and two bathrooms - one of which is en suite to the principal bedroom. The third bedroom is currently used as a dressing room with an extensive range of fitted wardrobes.

Knutsford is an extremely pretty town with narrow part-cobbled streets. It offers a range of day to day shopping facilities and has an abundance of restaurants, brasseries and other eateries to which people travel from far around. The town is also conveniently situated for the motorway network, being about 2½ miles to the M6 at junction 19. The M56 is about one mile further afield, providing access to Manchester city centre, Manchester International Airport and to the west, Chester and North Wales.



74c King Street Knutsford Cheshire WA16 6ED

Price: £699,950
 Tenure: Leasehold (999 years from 2004)
 Service Charge: approx £1,200 quarterly
 Local Auth: Cheshire East
 Council Tax Band: D

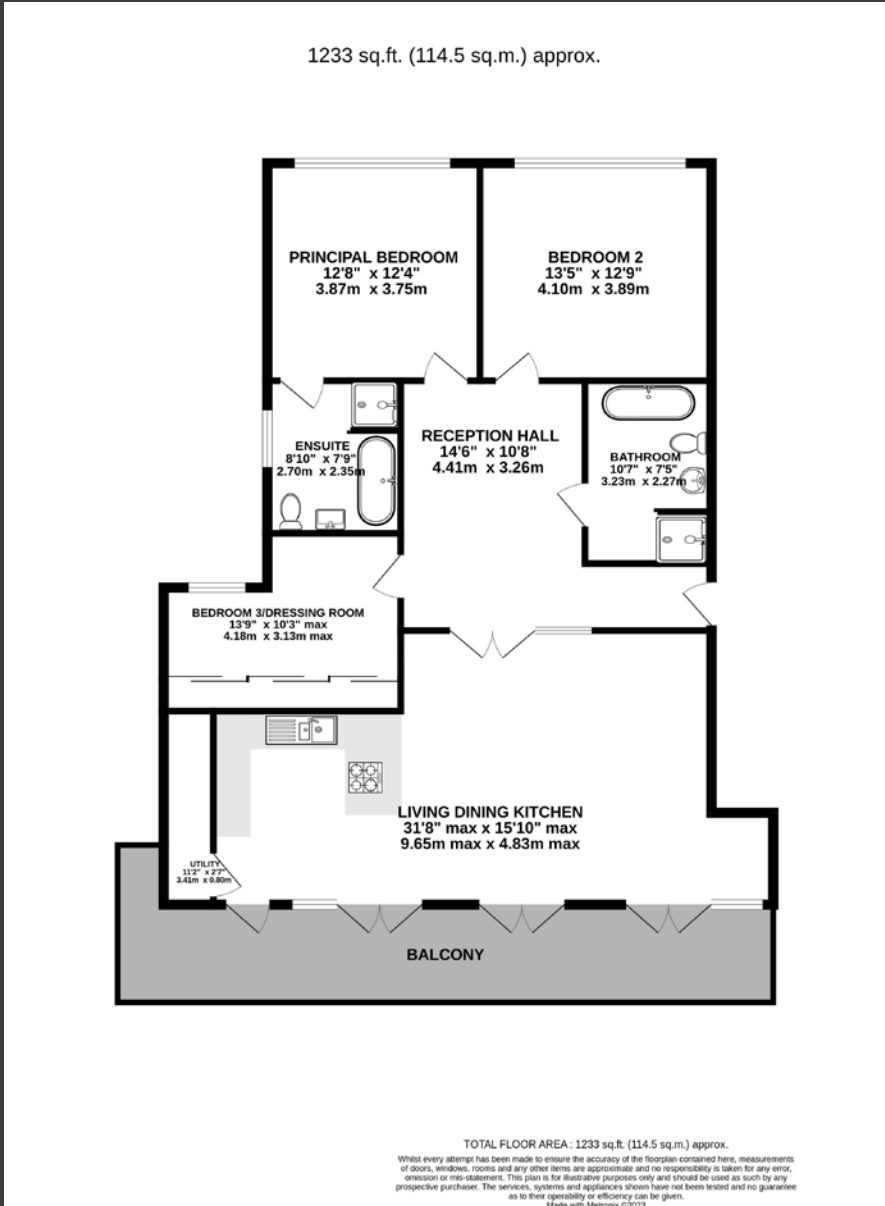
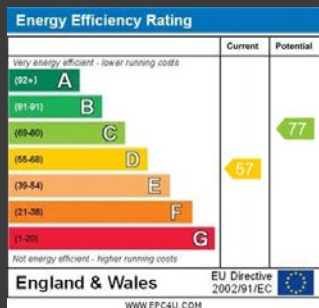

01565 757000
 35 King Street Knutsford Cheshire WA16 6DW
www.srushton.co.uk
enquiries@srushton.co.uk

IMPORTANT NOTICE: Stuart Rushton & Company, their solicitors and any joint agents give notice that: 1. They are not authorised to make or give any representations or warranties in relation to the property either here or elsewhere, either on their own behalf or on behalf of their client or otherwise. They assume no responsibility for any statement that may be made in these particulars, these particulars do not form part of any offer or contract and must not be relied upon as statements or representation of fact. 2. Any areas, measurements or distances are approximate. The text, photographs and plans are for guidance only and are not necessarily comprehensive. It should not be assumed that the property has all necessary planning, building regulations or other consents and Stuart Rushton & Company have not tested any services, equipment or facilities. Purchasers must satisfy themselves by inspection or otherwise.

